

Contents

ENGLISH	2
Vehicle Details.....	2
Installation Precautions	4
Parts View	5
Pre Installation	6
Installation.....	6
Compressor Installation	7
Drive Belt.....	7

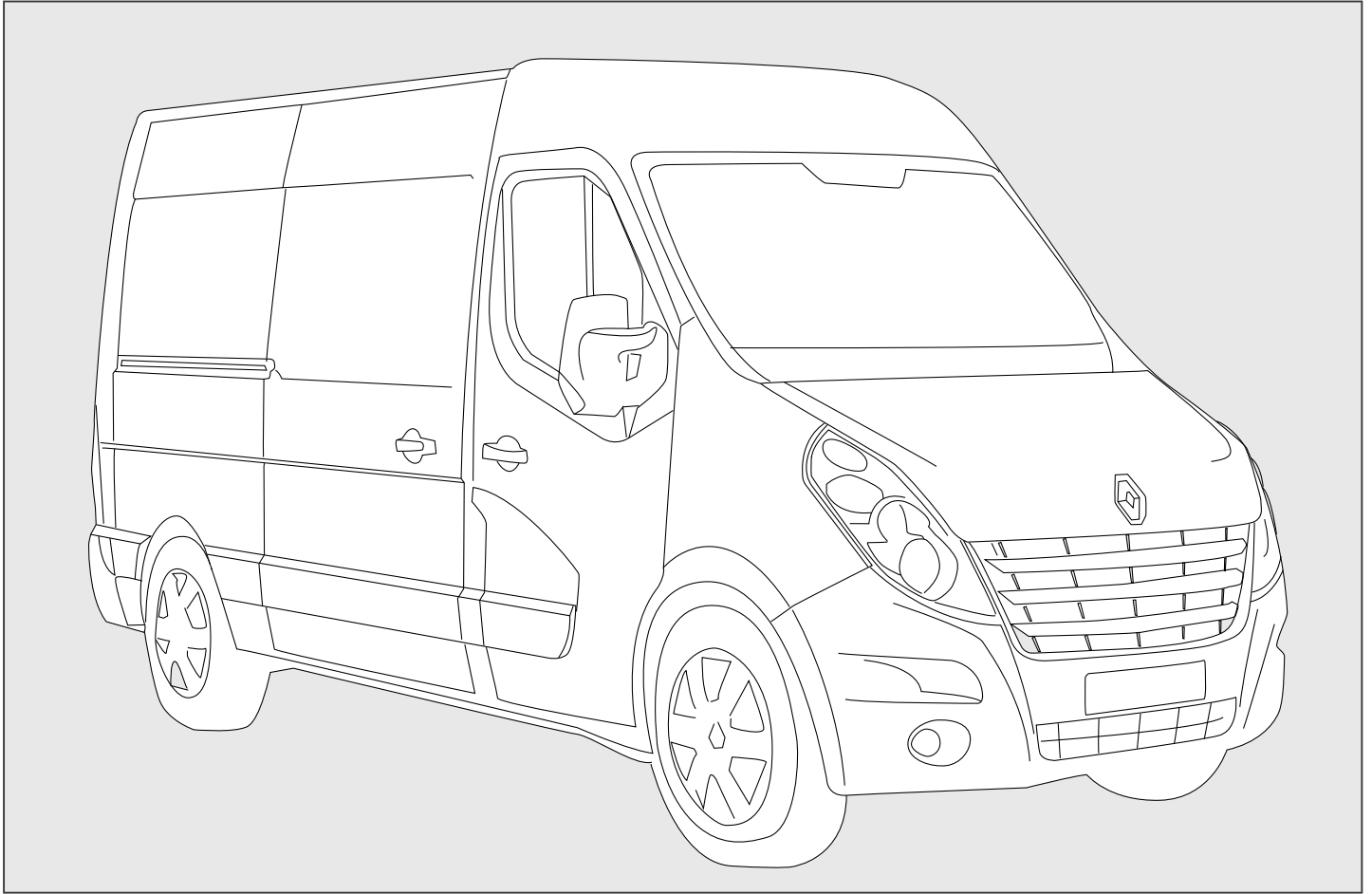

VEHICLE DETAILS

Manufacturer	Nissan / Renault / Vauxhall
Make	NV400 / Master , Movano
Model	2.3 dCi / CDTi - FWD
Engine	100/125/150 PS (2299CC)
Engine Details	M9T
Year	06.10>
Chassis Nos.	N/A
LHD	YES
RHD	YES
PAS	YES
A/C	NO
Voltage	12v

KIT DETAILS

Kit Part No.	0500.4372
Description	Standard Kit
Compressor RPM	4441 @ Max Engine
	Power Output
Fitting Time	45 Minutes
Suction Fitting	90°
Discharge Fitting	90°
Belt Type	7PK 2000
Belt Part No.	0820.2141
Note	Vehicles with Factory PTO Option Not suitable with Robotized gearbox or Stop / Start

RECOMMENDED COMPRESSORS

SELTEC	TM-13 HS	TM15-HS	TM16-HS
Comp No	0381.0152	0381.0802	-
Seltec No.	10354320	10355320	-
Mounting	Ear	Ear	-
Rotor	8PV	8PV	-
Armature	SL	SL	-
Diameter	123	123	-
Voltage	12	12	-
Orientation	V	V	-
Fitting	3/4 x 7/8	3/4 x 7/8	-
Manifold	Bolt	Bolt	-

QUE	QP13 HD	QP15 HD	QP16 HD
Comp No	0391.0152	0391.0802	-
QUE No.	QP13-1235	QP15-1761	-
Mounting	Ear	Ear	-
Rotor	8PV	8PV	-
Armature	SL	SL	-
Diameter	123	123	-
Voltage	12	12	-
Orientation	V	V	-
Fitting	3/4 x 7/8	3/4 x 7/8	-
Manifold	Bolt	Bolt	-

SANDEN	SD5H09	SD5H14	SD7H15
Comp No	-	-	-
Sanden No.	-	-	-
Mounting	-	-	-
Rotor	-	-	-
Armature	-	-	-
Diameter	-	-	-
Voltage	-	-	-
Orientation	-	-	-
Fitting	-	-	-

Notes

COMPRESSOR KIT CONFIGURATIONS

PART NUMBER	COMPRESSOR KIT PART NOS				DESCRIPTION	QTY.
	0513.4372	0515.4372	0593.4372	0595.4372		
0381.0152	●				TM13 Ear Mount 8PV SL 123 12V V 3/4 x 7/8 Bolt	1
0381.0802		●			TM15 Ear Mount 8PV SL 123 12V V 3/4 x 7/8 Bolt	1
0391.0152			●		QP13 Ear Mount 8PV SL 123 12V V 3/4 x 7/8 Bolt	1
0391.0802				●	QP15 Ear Mount 8PV SL 123 12V V 3/4 x 7/8 Bolt	1

● = Additional parts to standard kits.

FOREWORD

- The purpose of this manual is to facilitate the installation of a direct drive compressor. The information given is merely instructive, should any complications arise contact the Technical department. The manufacturer's warranty does not cover any problems caused by defective installation or alterations made unless authorised. The manufacturer shall not be responsible for any injury, damage or loss caused directly or indirectly as a result of using this manual or the information contained within it.

1 SAFETY MEASURES:

Before fitting the Compressor adapter drive kit, ensure the following for damage:

- Inner and outer trim and body work
- Engine idle pace
- Check all the vehicle functions

Check list:

- Ensure that the right kit has been selected
- Before installing, check that all the correct pieces are present; also ensure that there are no missing or broken pieces
- When fitting, make sure the vehicle is properly protected against damage.

Installation apparatus

- Calibrated torque wrench
- Hand service tools
- Protective covers and shields

2 PRECAUTIONS

- Detach the battery negative lead.
- Torque all bolts where stated using a calibrated torque wrench.
- Take extreme care with moving parts.
- Remove the vehicles ignition key and keep it with you.
- Wear safeguards to make sure that liquid refrigerant never touches your skin

Caution: Measures must be followed accurately to steer clear of the possibility of damage to individuals

Warning: This calls awareness to actions which must be pursued to avoid damage to the components.

NB: This calls awareness to make the job easier or gives useful information.

STANDARD FASTENER TORQUE VALUES

- In the absence of specific torque values detailed in this fitting instruction manual, the following chart can be used as a guide to the maximum safe torque for specific size and grade of fastener.

STRENGTH	4.8		8.8		10.9		12.9	
	Max Torque		Max Torque		Max Torque		Max Torque	
Dia / Pitch	lb.ft	Nm	lb.ft	Nm	lb.ft	Nm	lb.ft	Nm
M5 x 0.80	2	3	4.5	6	6.5	9	7.5	10
M6 x 1.00	4	5.5	7.5	10	11	15	13	18
M8 x 1.25	10	13	18	25	26	35	33	45
M10 x 1.25	20	27	39	53	57	78	66	90
M10 x 1.50	18	25	37	50	55	73	63	86
M12 x 1.75	33	45	63	85	97	130	111	150
M14 x 2.00	55	75	103	140	151	205	177	240
M16 x 2.00	85	115	159	215	232	315	273	370

PARTS VIEW

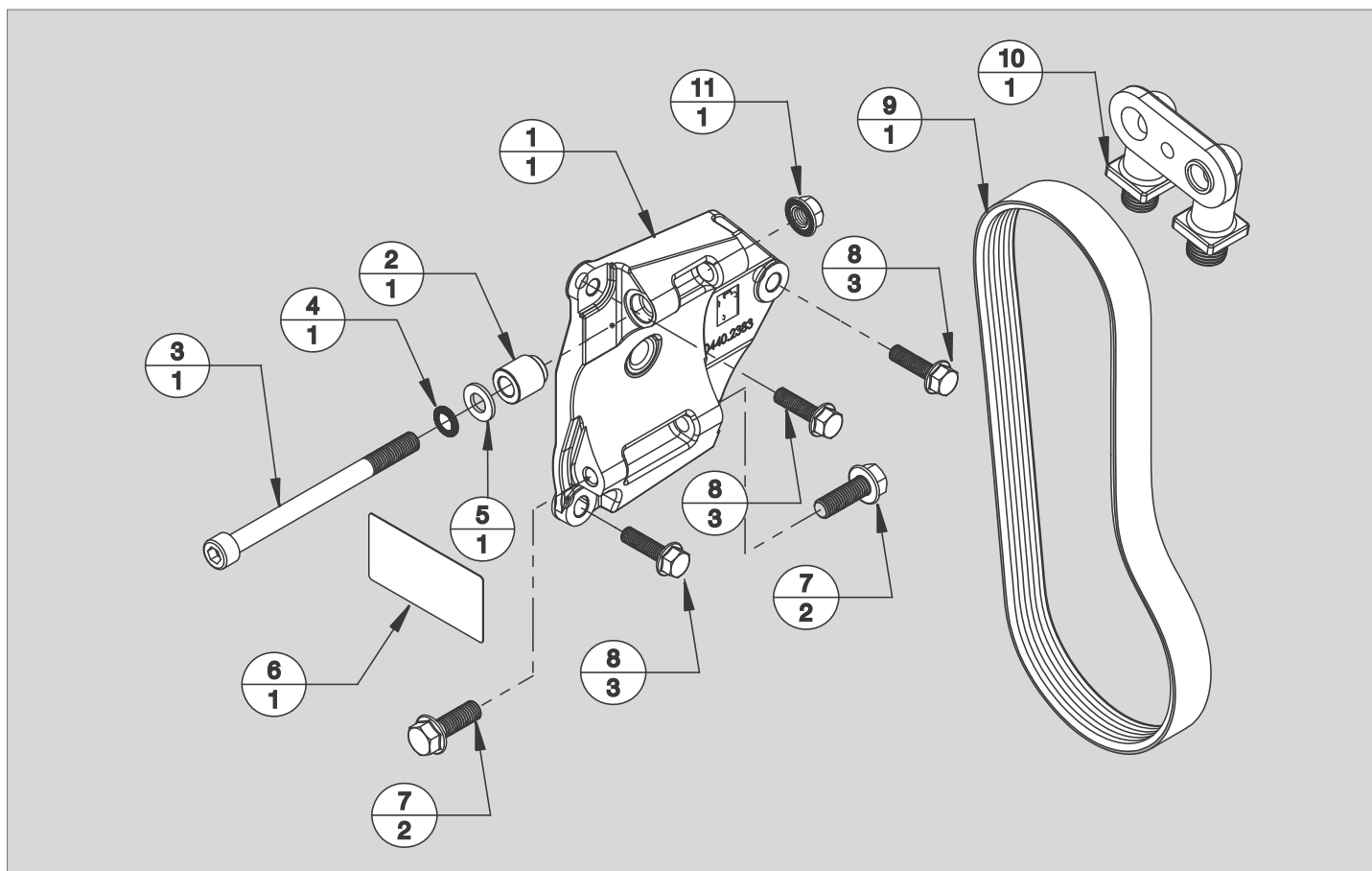

ITEM	PART NO.	DESCRIPTION	QTY.	COMMENTS
1	0440.2383	Compressor Mount Bracket	1	-
2	2803.3403	Compressor Spacer	1	-
3	2705.0301	Cap Screw M10 x 130	1	-
4	2809.0101	M10 Schnorr Washer	1	-
5	2809.0011	M10 Washer	1	-
6	2902.4372	Warning Label	1	-
7	2705.0491	M10 x 30 Set Screw	2	-
8	2704.0091	M8 x 30 Set Screw	3	-
9	0820.2141	Drive belt 7PK 2000	1	-
10	0425.0371	Seltec Inverted Manifold	1	-
11	2735.0071	M10 Locking Nut	1	-

PRE-INSTALLATION

Remove the following parts:

1. Take off and discard the original drive belt **(A)** - Fig 1. Please take note how the original belt is configured
2. Unscrew the M8 bolts **(B)** holding the original idle pulley assembly **(C)** - Fig 2.
3. Dispose of the original bolts **(B)** and pulley assembly **(C)** - Fig 2.

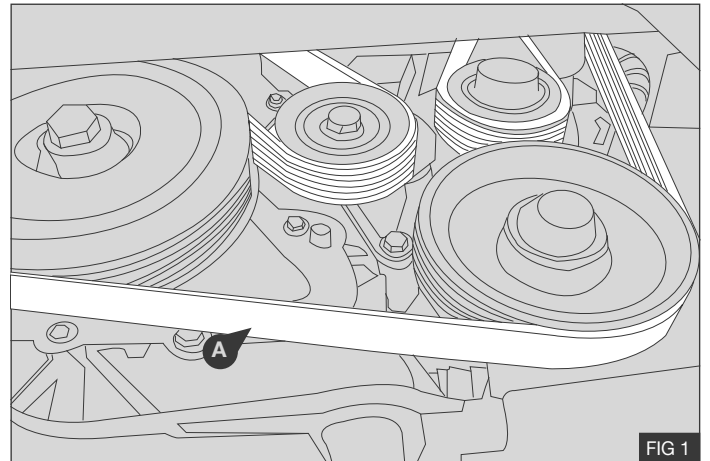

FIG 1

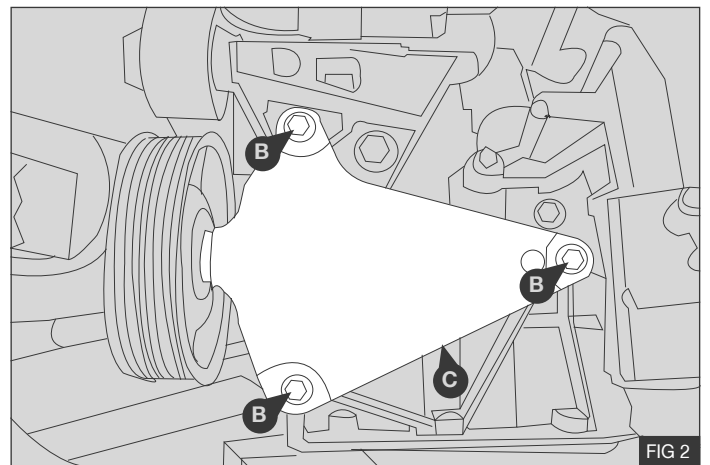

FIG 2

INSTALLATION

1. Install the supplied bracket **(1)** using bolts contained in the fastener pack **(8)** - Fig 3
2. Torque M8 x 30 bolts **(5)** to 29Nm / 21.4Lb ft - Fig 3

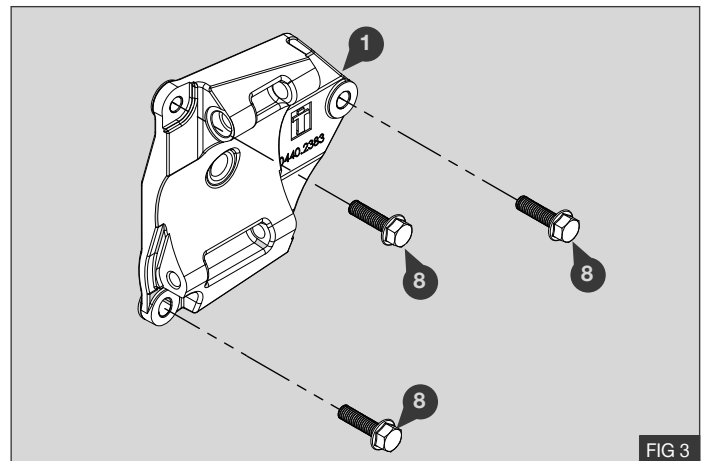

FIG 3

3. Install the spacer **(2)** as shown in - Fig 4

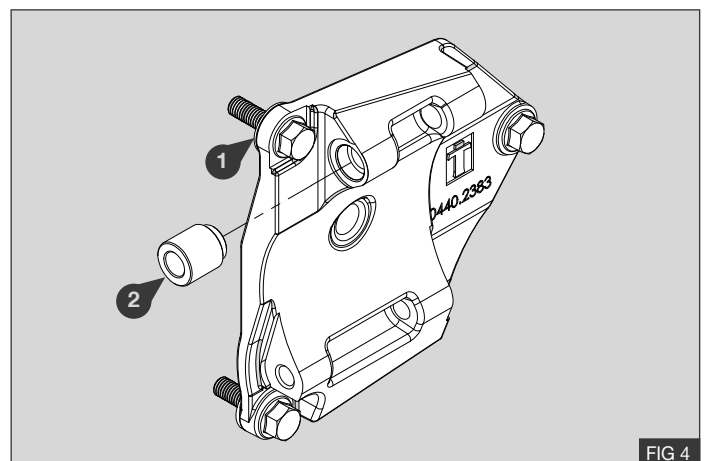

FIG 4

COMPRESSOR INSTALLATION

1. Install the inverted manifold 10 to the compressor using original bolt (F) - Fig 5.

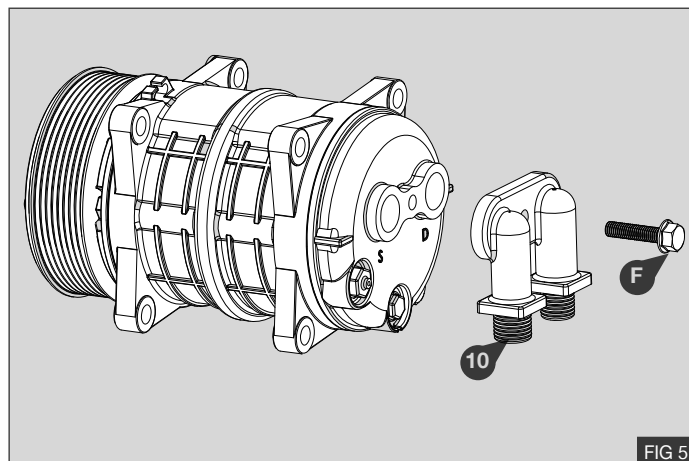

FIG 5

2. Attach the compressor to the mount bracket (1) by bolt (3) flat and locking washer (4), (5) and nut 11 Attach the base the compressor with bolts (7) - Fig 6
3. Torque M10 x 130 bolt (3) to 63Nm / 46Lb ft - Fig 6
4. Torque M10 x 30 bolts (7) to 58Nm / 43Lb ft - Fig 6

#

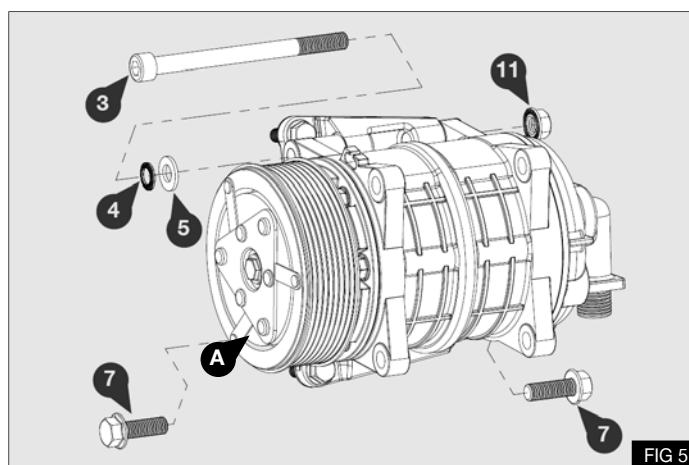

FIG 5

DRIVE BELT

1. Fit the supplied drive belt (9) to the vehicle in its original configuration

Notes